

ZHO-1348L/S Open Frame Solenoid

ISO/TS16949 ISO9000 ISO14000
RoHS REACH CE UL VDE TÜV



总重量 Total Weight: 240g
应用范围: 用于运动器材, 设备等
APPLICATION: Sports Equipment, Device etc

类型: 拉式 TYPE: PULL

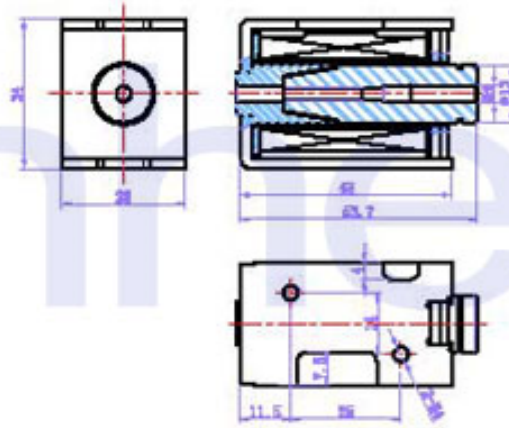

单位:mm Units:mm 通电状态 Shown Energized

拨杆外部与负载
连接的标准结构
plunger type

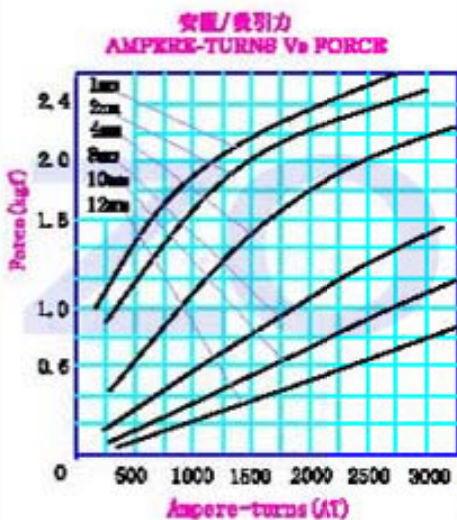
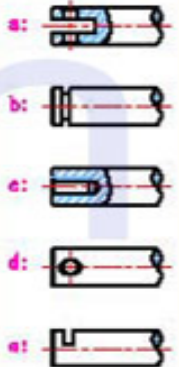

类型: 推式 TYPE: PUSH

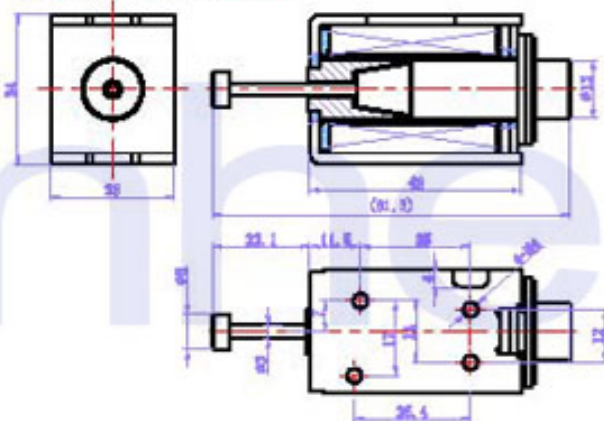

单位:mm Units:mm 通电状态 Shown Energized

拨杆外部与负载
连接的标准结构
push shaft type

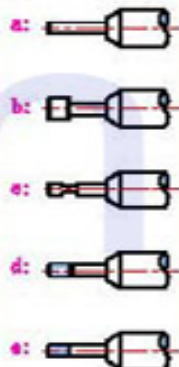

COIL DATA 线圈资料

| | | | | | |
|---|-----------------------------------|----------------------|-----------------------|----------------------|-----|
| 工作周期(%) = $\frac{\text{工作时间}}{\text{工作时间} + \text{断开时间}} \times 100\%$ Duty cycle (%) = $\frac{\text{"ON" time}}{\text{"ON" time} + \text{"OFF" time}} \times 100\%$ | 连续 Continuous 100% | 间断 Or less 60% | 间断 Or less 25% | 间断 Or less 10% | |
| 最大工作时间(秒) MAX. "on" time in seconds | ∞ | 60 | 18 | 3 | |
| 瓦特(W) (20℃) Watts at 20℃ | 6 | 12 | 24 | 40 | |
| 安匝数(AT) (20℃) Ampere-turns at 20℃ | 924 | 1025 | 1452 | 2262 | |
| 型号 Model No. | 阻值(20℃) Resistance (Ω) ±10% | 线圈匝数 Turns | 电压(VDC) DC Voltage | | |
| ZHO-1253L-XX A XX | 6 | 924 | 6 | 12 | 19 |
| L S 拉Pull 推Push | 26 | 2170 | 12 | 24 | 38 |
| 电压Voltage(V) 系列号Serial No. 0,1,2,3,4,5,6,7,8,9 | 144 | 4357 | 24 | 48 | 75 |
| 电阻Resistance(Ω) | 576 | 8537 | 48 | 96 | 152 |